

RECORD NORTH

100' 0 100'

GRAPHIC SCALE IN FEET
SCALE: 1"=100'

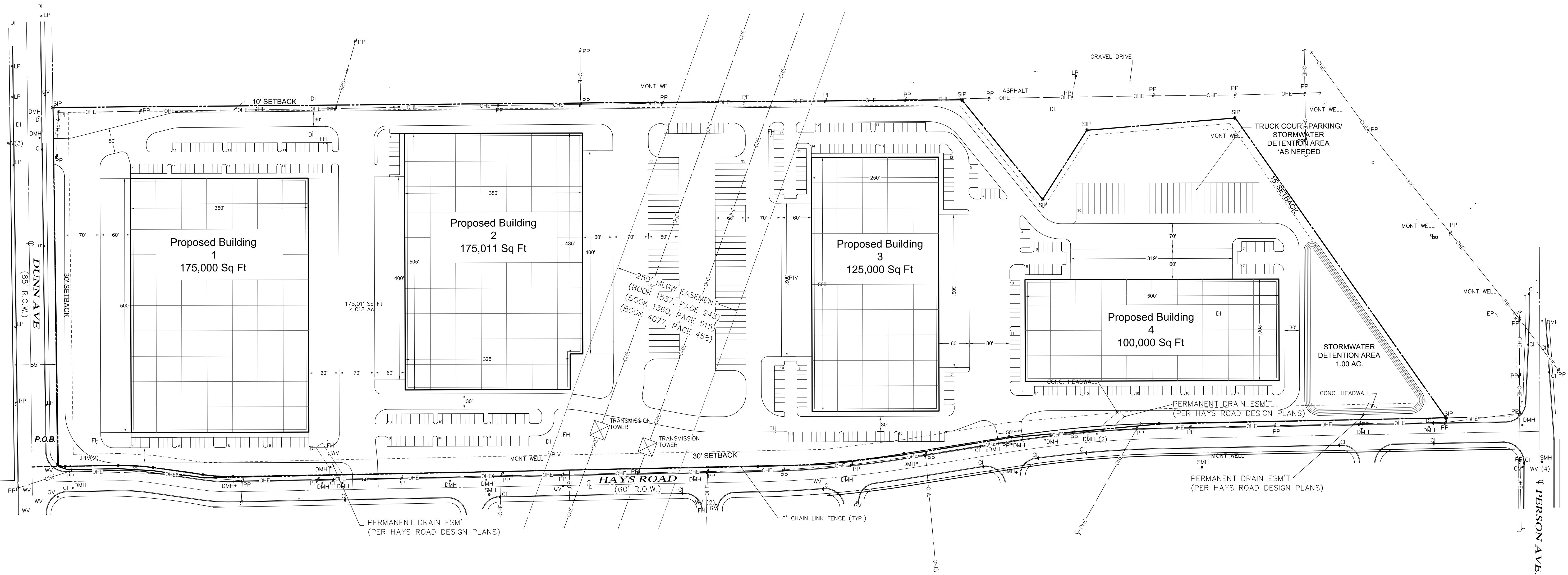

The Reaves Firm
INCORPORATED
Planning
Engineering
Landscape Architecture
Land Surveying
5880 Ridge Bend Road Memphis, TN 38117
901.761.2016 Fax: 901.763.2847
www.ReavesFirm.com

SEAL	PROJECT:	EXISTING DEPOT SITE DUNN AVENUE AND HAYES ROAD MEMPHIS, SHELBY COUNTY, TENNESSEE	SCALE: 1"=100'
	FOR:	STUART FRANKEL DEVELOPMENT COMPANY	DATE: 05/18/07
	SHEET TITLE:	SITE PLAN WITH SURVEY	DRAWN BY: BAH
			CHECKED BY: JHS
			JOB NO.: 07-0181
			SHEET NO.: 1